

Notes & Specifications	
Component	Description
End Caps	Corrosion resistant steel
Center Tube	Corrosion resistant steel
Pleat Pack	M = Dualglass fiber media A = Glass fiber w/water removal media L = Glass fiber media W = Stainless steel wire mesh SF = Dynafuzz stainless fiber media
Collapse Rating	450 psid
Filtration Rating	Bx = 200 Bx[c] = 1000

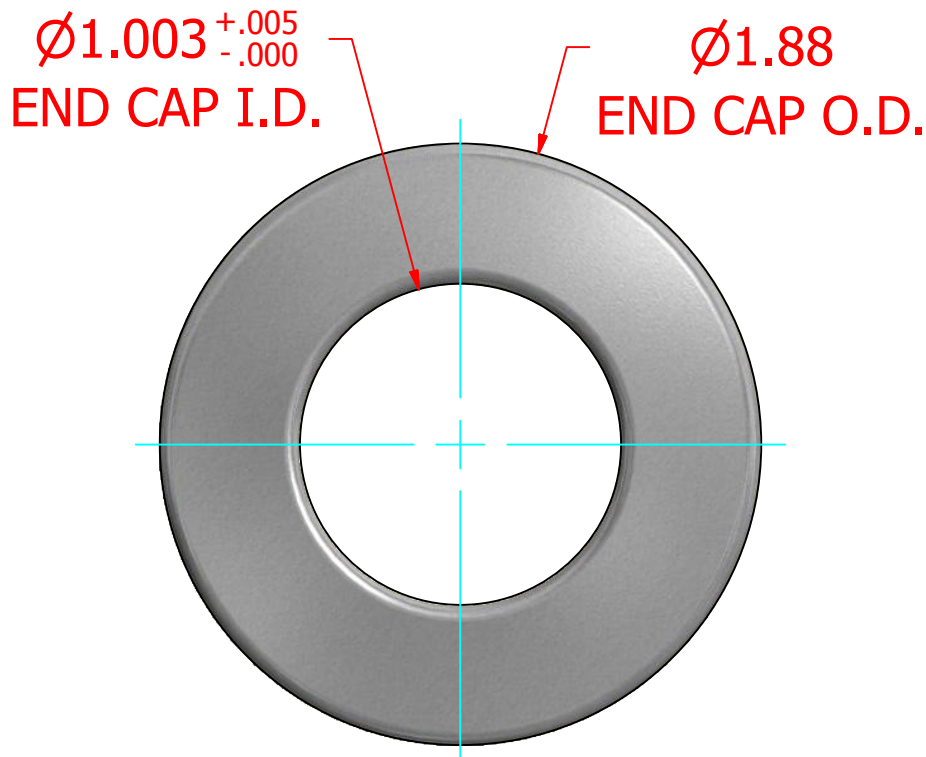
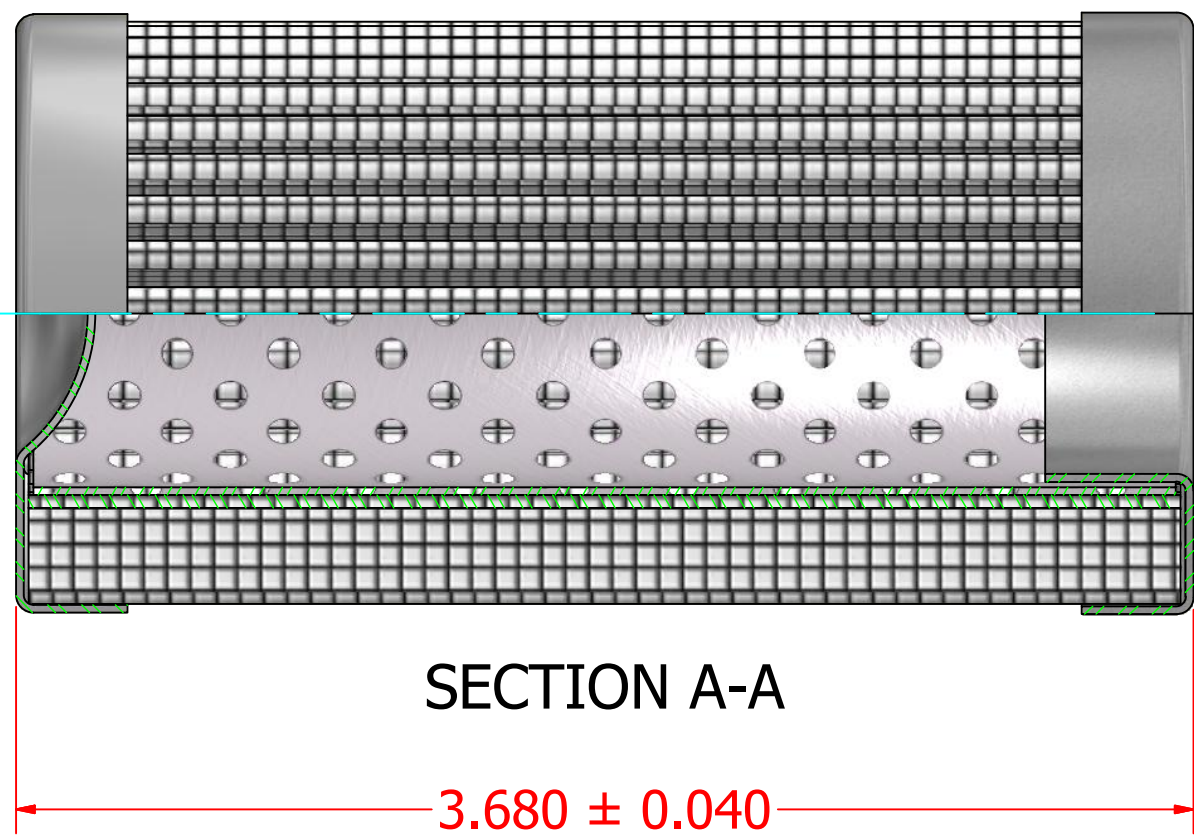
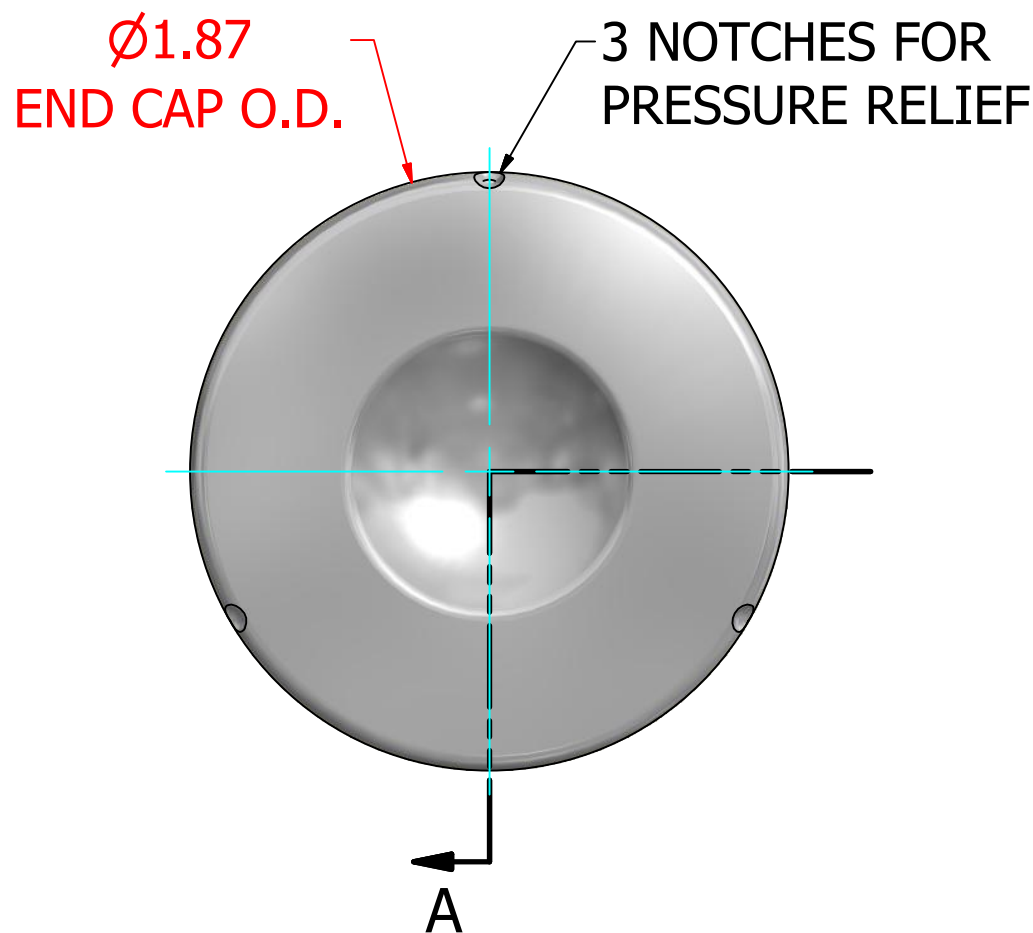

<div><div>HY-PRO</div><div>FILTRATION</div></div>	HY-PRO FILTRATION 6810 LAYTON ROAD ANDERSON, IN 46011 TEL: 317.849.3535 FAX: 317.849.9201 www.filterelement.com	DRAWN CLN	6/30/2015	PART NO	HP150L4-__ __ __			
		CHECKED JAW	6/30/2015	DESC	HY-PRO FILTER ELEMENT			
		APPROVED CLN	6/30/2015					
		THIS DRAWING IS THE EXCLUSIVE PROPERTY OF HY-PRO FILTRATION AND MUST NOT BE USED FOR ANY PURPOSE WHATSOEVER WITHOUT THE EXPRESS PERMISSION OF THE COMPANY.						
ALL DIMENSIONS IN INCHES (METRIC IN BRACKETS)	TOLERANCES UNLESS OTHERWISE STATED (IN)			SIZE C	DRAWING NO 15F-058		REV H	
	±.005" ON THREE PLACE DECIMAL ±.010" ON TWO PLACE DECIMAL ±.020" ON ONE PLACE DECIMAL			⋄ : ±1' ⊙ : .005" TIR ⊥ : .005" TIR		SCALE 1:1		SHEET 1 OF 1